



C.R.I. PUMPS

Pumping trust. Worldwide.

CENTRIFUGAL MONOBLOCK PUMPS - 60Hz

DIN Standard - Single Shaft

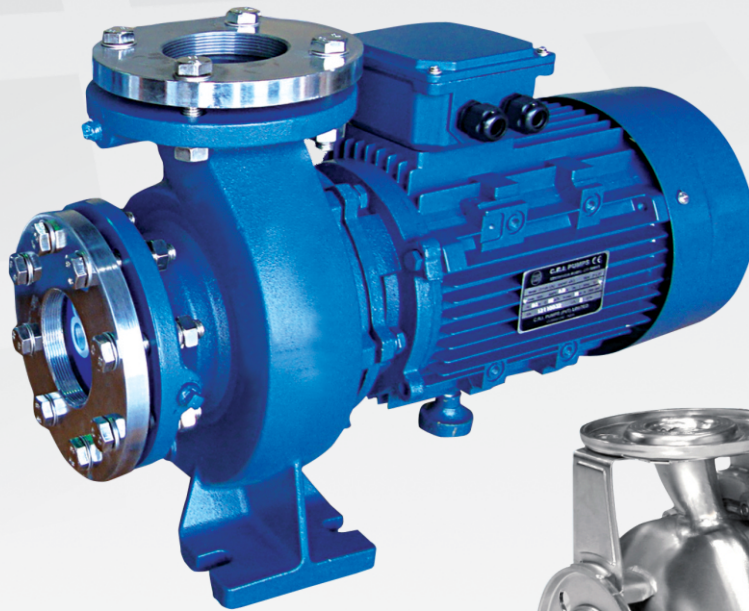

An ISO 9001 & 14001 Company



* For Specific models only.



C.R.I. PUMPS
Pumping trust. Worldwide.

T H E B E G I N N I N G

of C.R.I., way back in 1961, was a resolute attempt to produce a few irrigation equipments using the limited facilities of an in-house foundry. Eventually the founder's dream was coming true as the small production unit he started kept growing rapidly. Now, after more than five eventful decades, it is an enormous, widely reputed organization, which produces more than 1800 varieties of perfectly engineered pumps and motors and sells its products in numerous countries spread across 6 continents.

C . R . I . I S O N E A M O N G

the few pioneers in the world to produce 100% stainless steel submersible pumps. Having achieved a record production capacity of over 2 million pumps per annum, today C.R.I. is rubbing its shoulders with the best brands in the world, with advanced technology and safety standards as its hallmarks.

T H E I N F R A S T R U C T U R E

of C.R.I. is pretty comprehensive with state-of-the-art machineries and high potential in-house R&D recognised by the ministry of science and technology, Govt. of India - all within its own covered area of 300,000 square metres. The production environment is accredited with ISO 9001 & 14001 certifications and the products are CE, UR/UL, IEC, TSE & ISI certified. The R&D team always stays in tune with the changing scenario and seldom fails in coming up with outstanding solutions every time.

N E E D L E S S T O S A Y ,

behind this legendary growth lies the untiring, innovative, enthusiastic and dedicated team work. and, of course, a flawlessly maintained value system too. The name C.R.I. itself encapsulates the company's ethos: "Commitment, Reliability, Innovation".

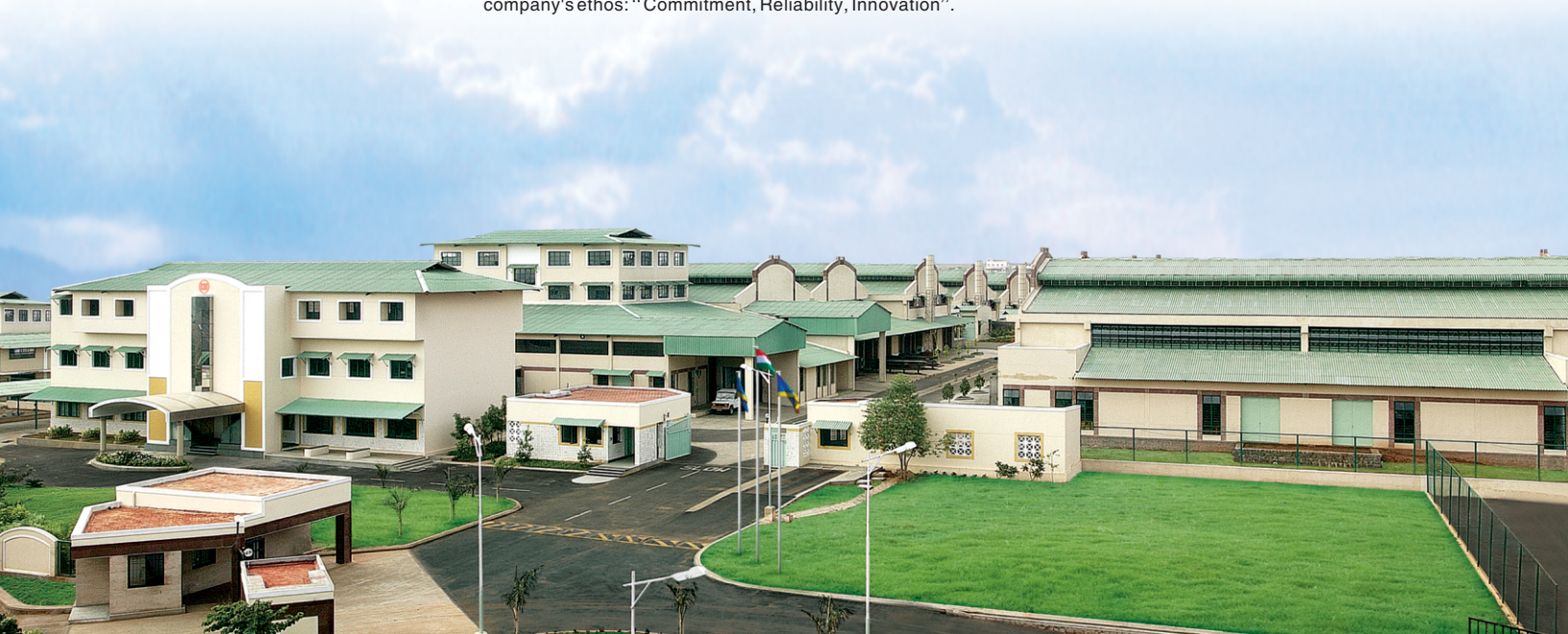

Centrifugal Pumps

DIN Standard - Single Shaft

CT SERIES

3 Phase

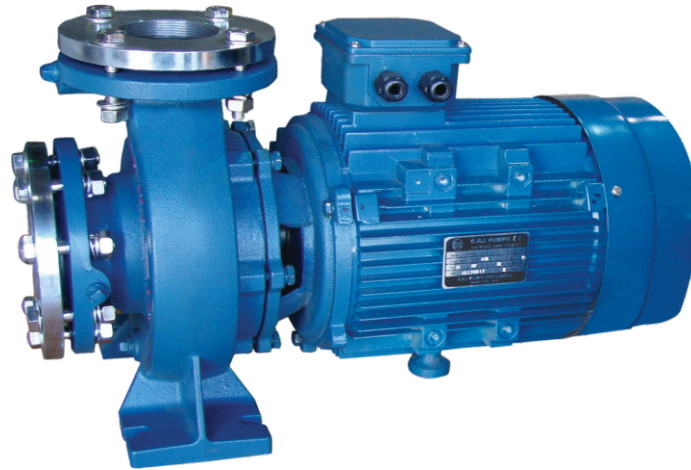

MODEL IDENTIFICATION CODE

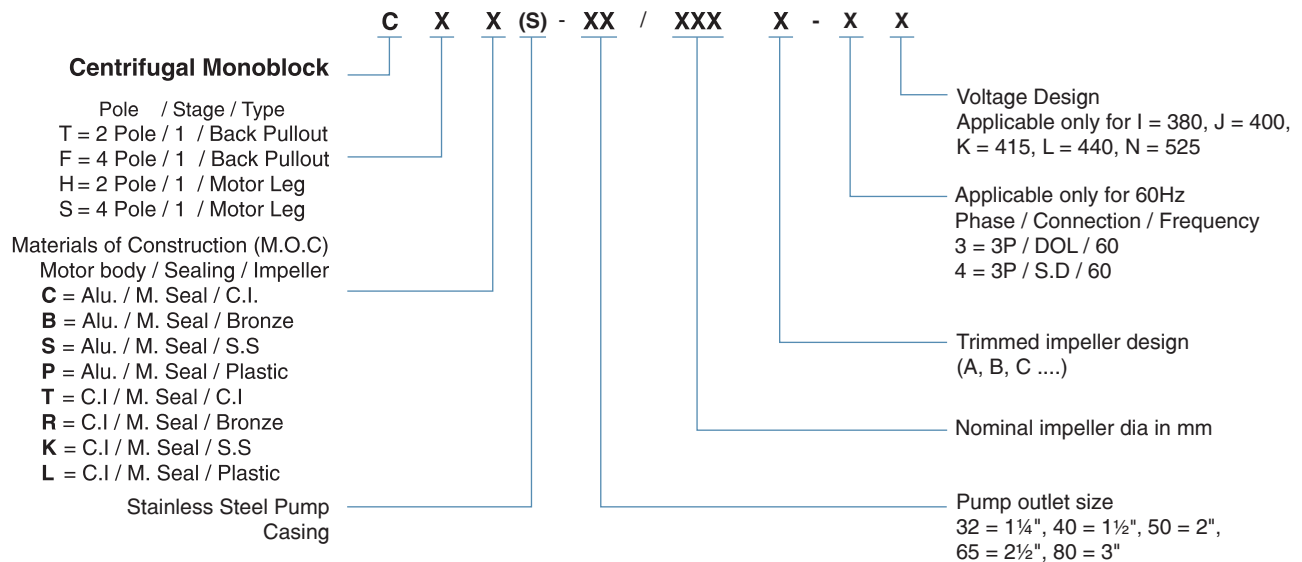

DESCRIPTION

C.R.I. Centrifugal pump's volute chamber and impellers are carefully designed to give the best possible hydraulic and suction lift characteristics. All dimensions and performances are according to EN733- DIN 24255 standards. Most modern and highly sophisticated machinery and technology are employed in the manufacture of these pumps using quality raw material, dynamically balanced impellers, seals and ball bearings to ensure long life. Dynamically balanced rotor ensures vibration and noise free operation. Shaft is made of quality steel, precision ground of ample size for transmitting the rated Horse Power.

SPECIFICATIONS

Power Range	10 HP to 50 HP
Speed	3450 rpm
Versions	Three Phase, 220V / 380V / 460V, 60Hz A.C Supply
Direction of Rotation	Clock wise viewed from driving end
Type of Duty	S1 (Continuous)
Degree of Protection	IP 55
Class of insulation	“F” / “B”
Nominal Suction & Delivery Size (mm)	50 x 32 65 x 40 65 x 50 80 x 65

MATERIALS OF CONSTRUCTION

Pump Casing	Cast Iron
Motor Frame	Aluminum (upto 10HP) and Cast Iron (12.5HP & above)
Impeller	Cast Iron / Bronze
Shaft	2 Cr 13 (S.S.)
Mechanical Seal	Carbon & Ceramic

PUMP OPERATING LIMITS

Maximum Head	265 ft / 80 m
Maximum Suction lift	23 ft / 7 m
Maximum Operating Temperature	194°F / 90°C
Maximum Ambient Temperature	104°F / 40°C

FEATURES

- Overall dimensions and performances are according to EN733- DIN 24255 standards
- High operating efficiency resulting in lower power consumption.
- Good suction lift characteristics.
- Dynamically balanced rotating parts including rotor and impeller.
- Balanced and rigid construction.

APPLICATIONS

Irrigation | Farms | Industrial Water Supply | General Water Supply | Drip and Sprinkler Systems | Water Treatment Plants | Residential

PERFORMANCE CURVES

CT SERIES

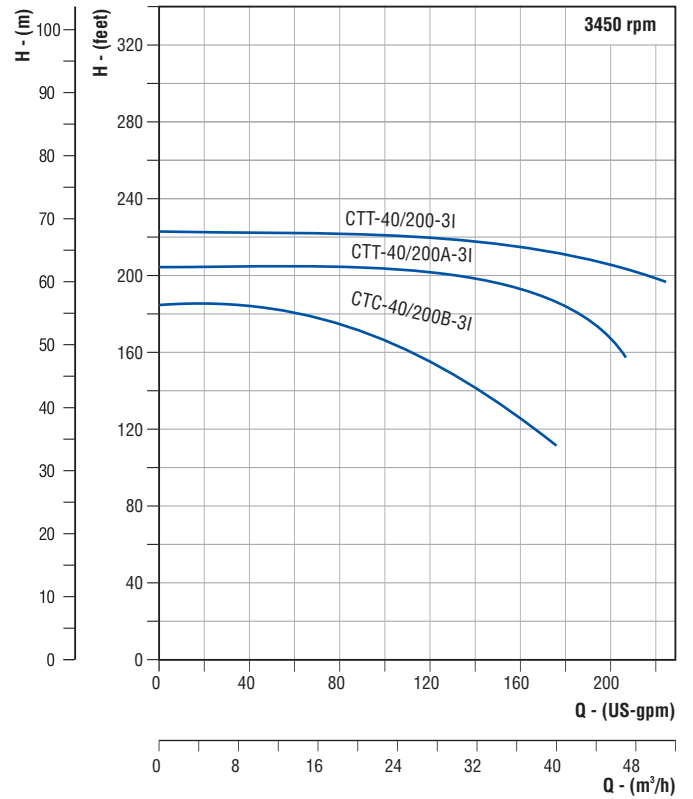
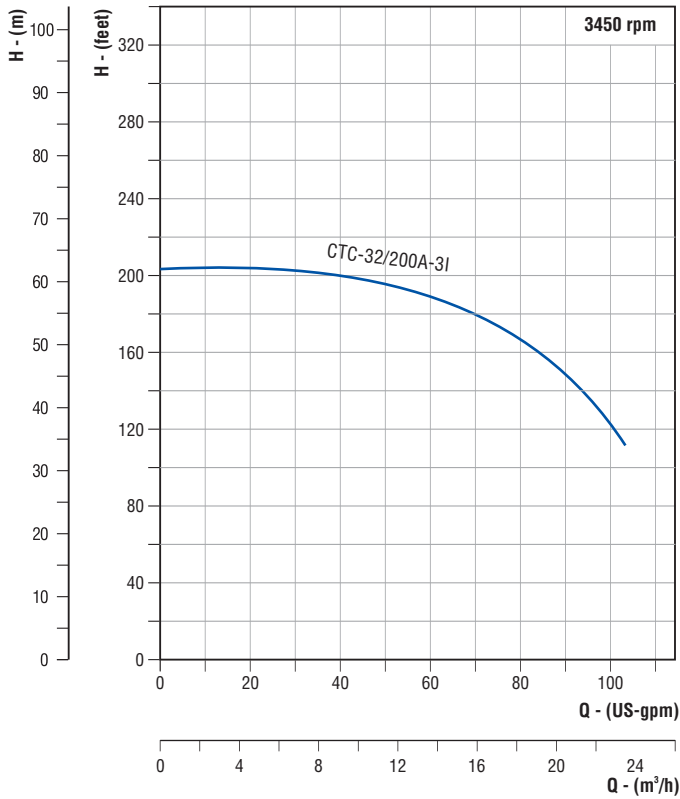

PERFORMANCE TABLE

Nominal Pump Size : **50 x 32**

Model	HP	kW	m³/h	0	4.54	9.08	13.63	18.17	22.71
				US-gpm	0	20	40	60	80
CTC-32/200A-3I	10	7.5	Head in feet	202	202	200	188	166	122

Nominal Pump Size : **65 x 40**

Model	HP	kW	m³/h	0	9.08	18.17	27.25	36.34	45.42	51.10
				US-gpm	0	40	80	120	160	200
CTC-40/200B-3I	10	7.5	Head in feet	183	183	175	154	126	112 (175gpm)	
CTT-40/200A-3I	15	11	Head in feet	204	204	204	201	192	167	156 (205gpm)
CTT-40/200-3I	20	15	Head in feet	222	222	221	219	215	205	196

Curve tolerance according to ISO 9906, Annex A.

The performance data are at rated voltage and only indicative. Actual discharge depends on availability of water / tank, height of water column from the suction pipe end.

In view of continuous developments the information / performance / descriptions / specifications / illustrations are subject to change without notice.

PERFORMANCE CURVES

CT SERIES

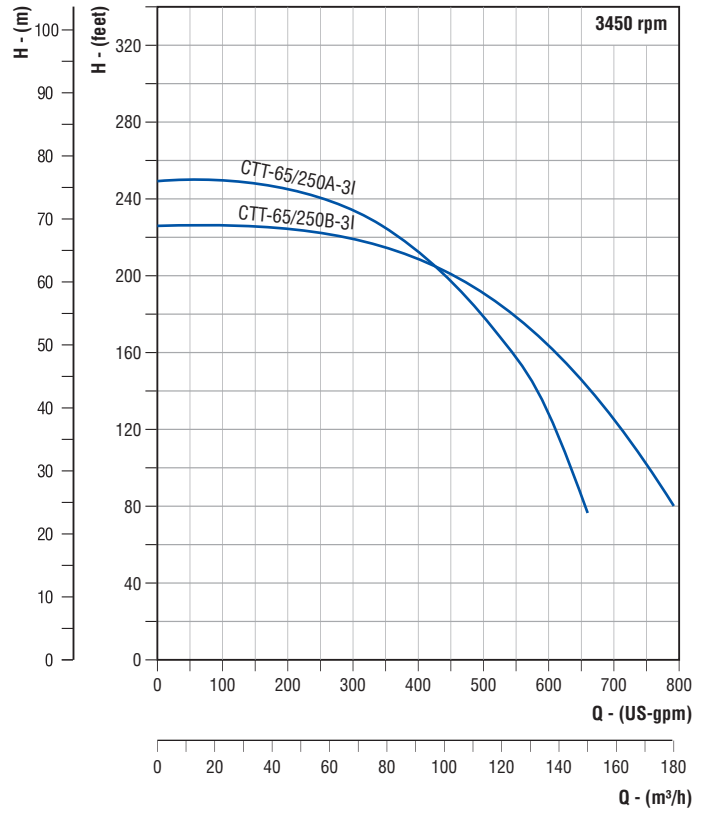
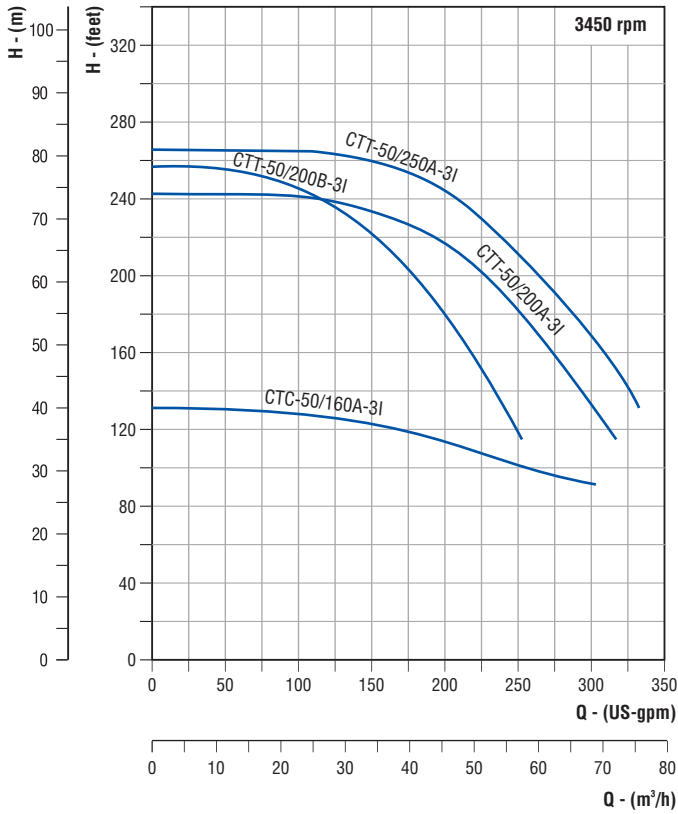

PERFORMANCE TABLE

Nominal Pump Size : **65 x 50**

Model	HP	kW	m³/h	0	11.36	22.71	34.07	45.42	56.78	68.14	74.95
				US-gpm	0	50	100	150	200	250	300
CTC-50/160A-3I	10	7.5	Head in feet	131	130	128	124	114	102	96	
CTT-50/200B-3I	20	15		256	255	245	222	180	118		
CTT-50/200A-3I	25	18.5		243	243	242	234	216	182	132	115 (315gpm)
CTT-50/250A-3I	30	22		265	265	265	260	244	210	169	132

Nominal Pump Size : **80 x 65**

Model	HP	kW	m³/h	0	22.71	45.42	68.14	90.85	113.56	136.27	158.98	179.43
				US-gpm	0	100	200	300	400	500	600	700
CTT-65/250B-3I	40	30	Head in feet	225	225	224	218	207	190	164	125	80
CTT-65/250A-3I	50	37		248	248	245	233	212	178	127	78 (660gpm)	

Curve tolerance according to ISO 9906, Annex A.

The performance data are at rated voltage and only indicative. Actual discharge depends on availability of water / tank, height of water column from the suction pipe end.

In view of continuous developments the information / performance / descriptions / specifications / illustrations are subject to change without notice.

DIMENSIONAL DRAWING

CT SERIES

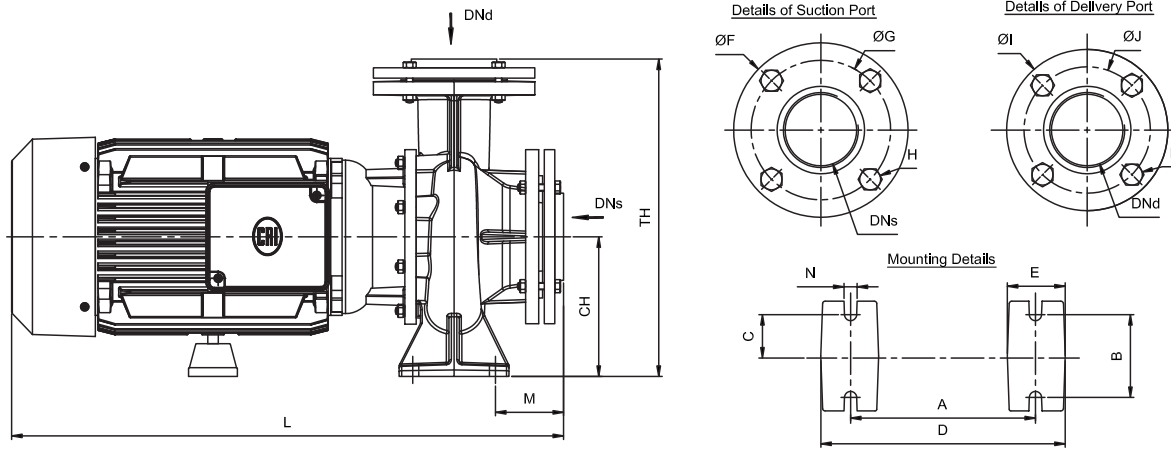

DIMENSIONAL DATA

MODEL	HP	DN _s	DN _d	L	CH	TH	A	B	C	D	E	M	N	ØF	ØG	H	ØI	ØJ	K	Weight in kg
CTC-32/200A-3I	10	50	32	575	160	365	190	70	35	240	50	68	14	165	125	18	140	100	18	80
CTC-40/200B-3I	10	65	40	590	160	365	212	70	35	265	50	88	14	185	145	18	150	110	18	82
CTT-40/200A-3I	15	65	40	670	160	365	212	70	35	265	50	88	14	185	145	18	150	110	18	132
CTT-40/200-3I	20	65	40	670	160	365	212	70	35	265	50	88	14	185	145	18	150	110	18	147
CTC-50/160A-3I	10	65	50	595	160	365	212	70	35	265	50	88	14	185	145	18	165	125	18	75
CTT-50/200B-3I	20	65	50	670	160	365	212	70	35	265	50	88	14	185	145	18	165	125	18	152
CTT-50/200A-3I	25	65	50	670	160	365	212	70	35	265	50	88	14	185	145	18	165	125	18	160
CTT-50/250A-3I	30	65	50	650	180	430	250	95	47.5	320	65	76	14	185	145	18	165	125	18	188
CTT-65/250B-3I	40	80	65	1073	200	478	280	120	60	360	80	70	19	200	160	18	185	145	18	311
CTT-65/250A-3I	50	80	65	1083	200	478	280	120	60	360	80	70	19	200	160	18	185	145	18	296

* All Dimensions are in mm.

Stainless Steel
Centrifugal Pumps
DIN Standard - Single Shaft

CTSS SERIES
3 Phase



DESCRIPTION

C.R.I. Centrifugal pump's volute chamber and impellers are carefully designed to give the best possible hydraulic and suction lift characteristics. All dimensions are according to DIN 24255 standards. Most modern and highly sophisticated machinery and technology are employed in the manufacture of these pumps using quality raw material, dynamically balanced impellers, seals and ball bearings to ensure long life. Dynamically balanced rotor ensures vibration and noise free operation. Shaft is made of quality steel, precision ground of ample size for transmitting the rated Horse Power. The pump portion is made of complete stainless steel construction which is more suitable for potable water.

SPECIFICATIONS

Power Range	1.5 HP to 25 HP
Speed	3450 rpm
Versions	Three Phase, 220V / 380V / 460V, 60Hz A.C Supply
Direction of Rotation	Clock wise viewed from driving end
Type of Duty	S1 (Continuous)
Degree of Protection	IP 55
Class of insulation	"F"
Nominal Suction & Delivery Size (mm)	50 x 32 65 x 40 65 x 50

MATERIALS OF CONSTRUCTION

Pump Casing	S.S 304 / S.S 316
Motor Frame	Aluminum (Upto 20HP) Cast Iron (25HP)
Impeller	S.S 304 / S.S 316
Shaft	S.S. 304
Mechanical Seal	Carbon & Ceramic

PUMP OPERATING LIMITS

Maximum Head	265 ft / 80 m
Maximum Suction lift	23 ft / 7 m
Maximum Operating Temperature	158°F / 70°C
Maximum Ambient Temperature	104°F / 40°C
Maximum Working Pressure	145 PSI

FEATURES

- All wetted components are made of corrosion resistance stainless steel.
- Designed to give best hydraulic efficiency and suction lift characteristics.
- Wear resistant bearing ensure noiseless operation.
- Back pull out design facilitates dismantling the pump without disconnecting the pipe lines.
- DIN Standard flange connections.

APPLICATIONS

Industrial water supply | Food processing industries | Pressure boosting units | HVAC | Washing systems | Irrigation etc.,

PERFORMANCE CURVES

CTSS SERIES

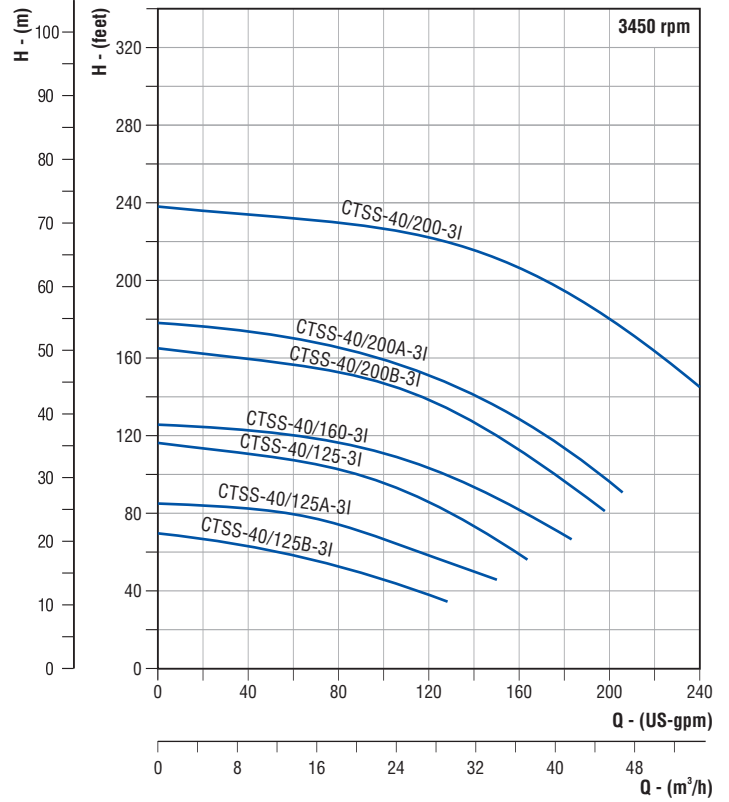
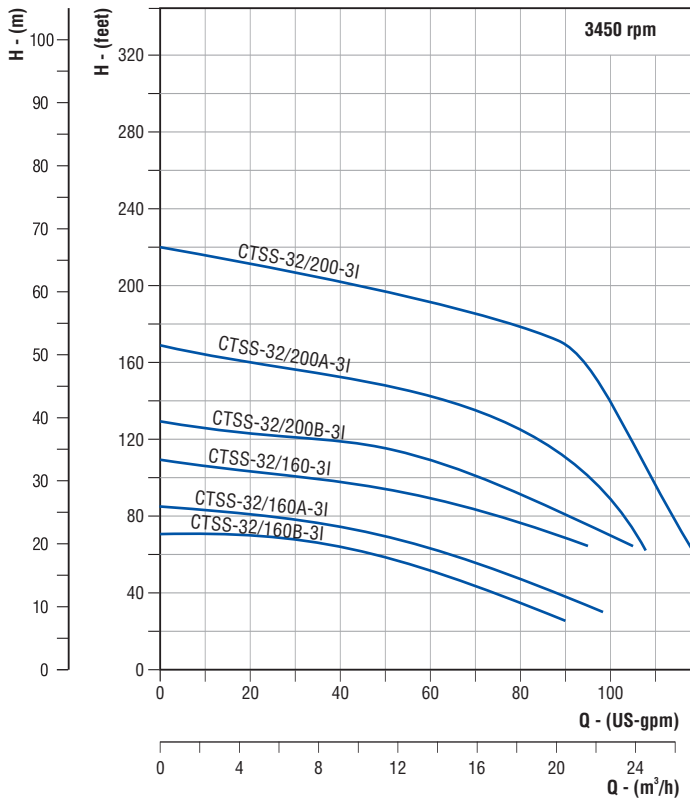

PERFORMANCE TABLE

Nominal Pump Size : **50 x 32**

Model	HP	kW	m³/h	0	4.54	9.08	13.63	18.17	22.71	27.25
				US-gpm	0	20	40	60	80	100
CTSS-32/160B-3I CTSS-32/160A-3I CTSS-32/160-3I CTSS-32/200B-3I CTSS-32/200A-3I CTSS-32/200-3I	1.5 2 3 4 5.5 7.5	1.1 1.5 2.2 3 4 5.5	Head in feet	72	69	65	50	34	26 (90gpm)	
				85	81	74	64	48	30 (98gpm)	
				108	104	97	88	76	64 (95gpm)	
				128	124	118	98	90	70	65 (105gpm)
				167	160	152	144	125	88	64 (107gpm)
				220	211	203	191	178	140	64

Nominal Pump Size : **65 x 40**

Model	HP	kW	m³/h	0	9.08	18.17	27.25	36.34	45.42	54.51
				US-gpm	0	40	80	120	160	200
CTSS-40/125B-3I CTSS-40/125A-3I CTSS-40/125-3I CTSS-40/160-3I CTSS-40/200B-3I CTSS-40/200A-3I CTSS-40/200-3I	2 3 4 5.5 7.5 10 15	1.5 2.2 3 4 5.5 7.5 11	Head in feet	68	64	52	38	35 (128gpm)		
				85	83	73	58	45 (150gpm)		
				116	110	103	86	58		
				125	124	116	104	83	67 (184gpm)	
				165	159	152	138	112	82 (118gpm)	
				178	174	165	150	128	95	96 (206gpm)
				238	233	229	224	207	180	146

Curve tolerance according to ISO 9906, Annex A.

The performance data are at rated voltage and only indicative. Actual discharge depends on availability of water / tank, height of water column from the suction pipe end.

In view of continuous developments the information / performance / descriptions / specifications / illustrations are subject to change without notice.

PERFORMANCE CURVES

CTSS SERIES

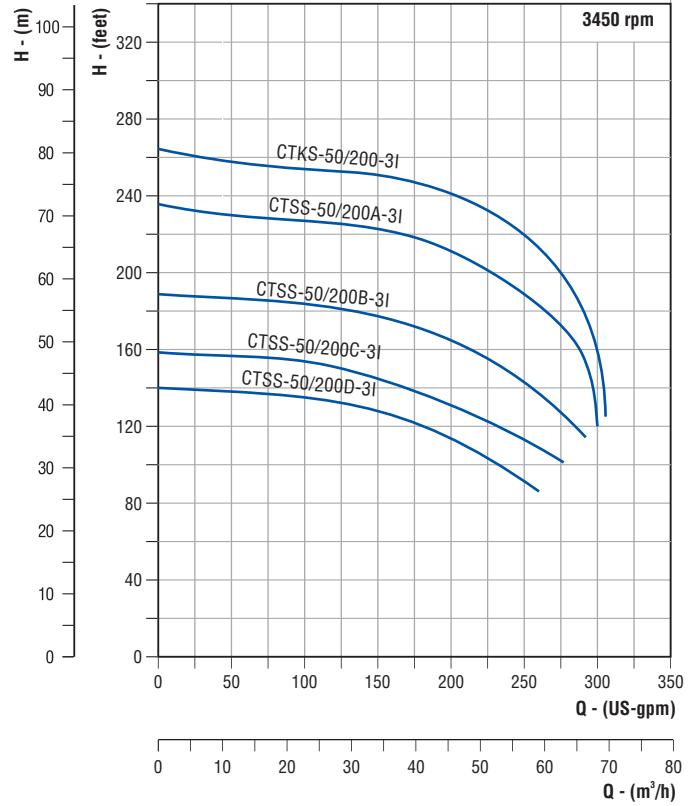
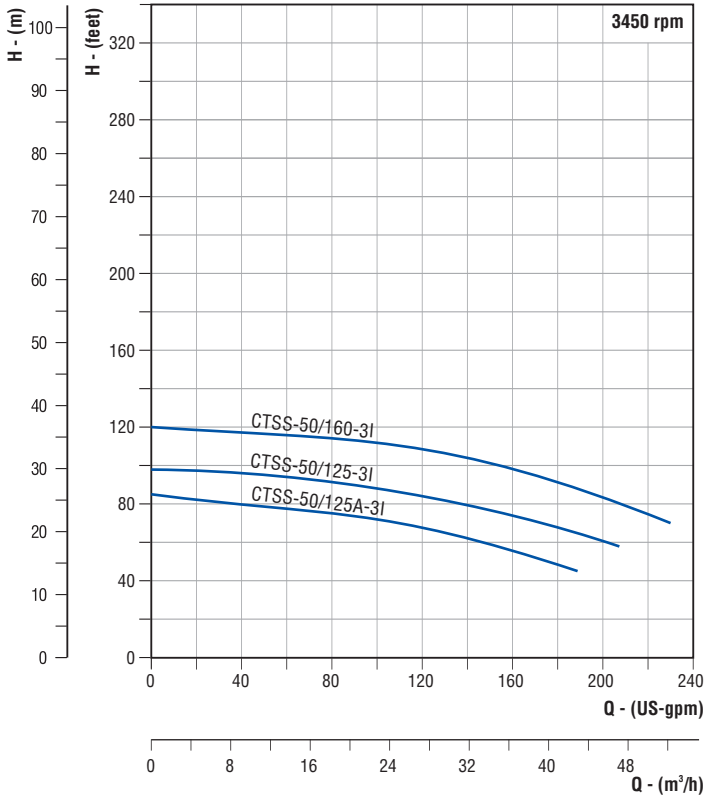

PERFORMANCE TABLE

Nominal Pump Size : **65 x 50**

Model	HP	kW	m³/h	0	9.08	18.17	27.25	36.34	45.42	52.24
				US-gpm	0	40	80	120	160	200
CTSS-50/125A-3I	4	3	Head in feet	85	80	75	67	55	45 (188gpm)	
CTSS-50/125-3I	5.5	4		97	96	92	82	74	61	56 (208gpm)
CTSS-50/160-3I	7.5	5.5		120	117	114	108	97	84	210

Nominal Pump Size : **65 x 50**

Model	HP	kW	m³/h	0	11.36	22.71	34.07	45.42	56.78	69.27
				US-gpm	0	50	100	150	200	250
CTSS-50/200D-3I	10	7.5	Head in feet	140	137	135	128	112	90	87 (265gpm)
CTSS-50/200C-3I	12.5	9.2		158	156	152	145	130	112	102 (275gpm)
CTSS-50/200B-3I	15	11		188	186	184	176	165	144	114 (290gpm)
CTSS-50/200A-3I	20	15		235	265	227	224	210	188	120 (300gpm)
CTKS-50/200-3I	25	18.5		265	256	253	250	241	220	125

Curve tolerance according to ISO 9906, Annex A.

The performance data are at rated voltage and only indicative. Actual discharge depends on availability of water / tank, height of water column from the suction pipe end.

In view of continuous developments the information / performance / descriptions / specifications / illustrations are subject to change without notice.

DIMENSIONAL DRAWING

CTSS SERIES

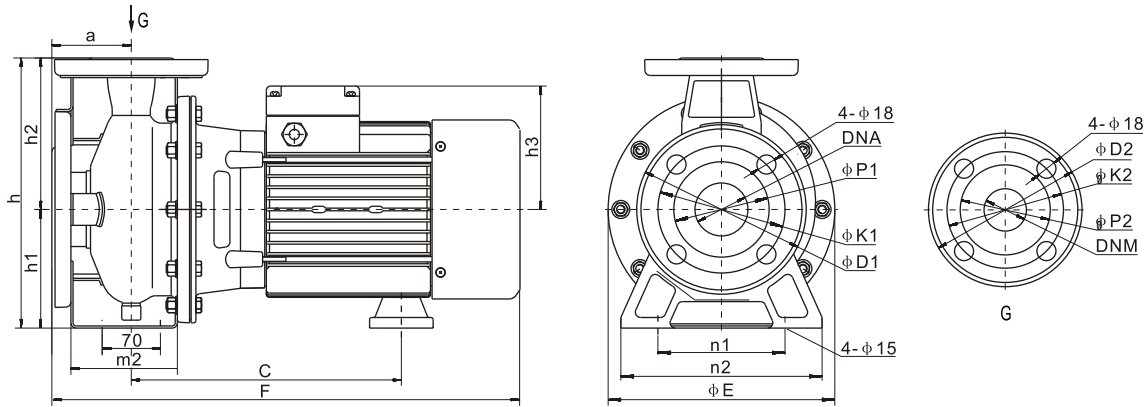

DIMENSIONAL DATA

MODEL	HP	ØE	F	h	h1	h2	h3	a	m2	n1	n2	C	ØD1	ØK1	ØP1	ØD2	ØK2	ØP2	DNs	DNd	WEIGHT IN kg
CTSS-32/160B-3I	1.5	210	395	255	112	143	134	80	115	160	190	215	165	125	96	140	100	76	50	32	19.7
CTSS-32/160A-3I	2	210	395	255	112	143	134	80	115	160	190	215	165	125	96	140	100	76	50	32	23
CTSS-32/160-3I	3	210	438	255	112	143	119	80	118	160	190	245	165	125	96	140	100	76	50	32	27.7
CTSS-32/200B-3I	4	300	450	340	160	180	119	80	118	190	240	245	165	125	96	140	100	76	50	32	35.5
CTSS-32/200A-3I	5.5	300	498	340	160	180	142	80	118	190	240	257	165	125	96	140	100	76	50	32	56.3
CTSS-32/200-3I	7.5	300	532	340	160	180	162	80	115	190	240	272	165	125	96	140	100	76	50	32	67.4
CTSS-40/125B-3I	2	210	395	255	112	143	134	80	115	160	190	215	185	145	115	150	110	80	65	40	23
CTSS-40/125A-3I	3	210	438	255	112	143	119	80	118	160	190	245	185	145	115	150	110	80	65	40	26.5
CTSS-40/125-3I	4	260	450	295	132	160	119	80	118	190	240	245	185	145	115	150	110	80	65	40	32
CTSS-40/160-3I	5.5	260	498	295	132	160	142	80	118	190	240	258	185	145	115	150	110	80	65	40	53.8
CTSS-40/200B-3I	7.5	300	554	360	160	200	162	100	118	212	264	274	185	145	115	150	110	80	65	40	67.5
CTSS-40/200A-3I	10	300	595	360	160	200	162	100	118	212	264	274	185	145	115	150	110	80	65	40	78.6
CTSS-40/200-3I	15	300	623	360	160	200	179	100	118	212	264	335	185	145	115	150	110	80	65	40	96
CTSS-50/125A-3I	4	260	455	295	132	160	119	80	115	190	240	245	185	145	115	165	125	96	65	50	32.2
CTSS-50/125-3I	5.5	260	498	295	132	160	142	80	115	190	240	258	185	145	115	165	125	96	65	50	54
CTSS-50/160-3I	7.5	300	554	360	160	200	162	100	118	212	264	274	185	145	115	165	125	96	65	50	68
CTSS-50/200D-3I	10	300	595	360	160	200	162	100	118	212	264	274	185	145	115	165	125	96	65	50	78.6
CTSS-50/200C-3I	12.5	300	623	360	160	200	179	100	118	212	264	335	185	145	115	165	125	96	65	50	86.5
CTSS-50/200B-3I	15	300	623	360	160	200	179	100	118	212	264	335	185	145	115	165	125	96	65	50	96
CTSS-50/200A-3I	20	300	665	360	160	200	179	100	118	212	264	335	185	145	115	165	125	96	65	50	115
CTKS-50/200-3I	25	350	725	360	160	200	255	100	118	212	264	429	185	145	115	165	125	96	65	50	152

* All Dimensions are in mm.

W I N N I N G W A Y S

When you have a good thing going it is quite in the fitting of things that recognitions come our way. Several prestigious awards, which decorate our shelf, say it all. These rewards not only acknowledge our position as a leader in the water pump industry but also serve as reminders about what the customer expects from a winner. And we, as ever, have our ears perfectly tuned to customer expectations.



C.R.I. PUMPS (PVT) LIMITED

(International Division)

7/46-1, Keeranatham Road, Saravanampatty, Coimbatore - 641 035. India.

Phone : +91-422-3911610, 3911612. Fax : +91-422-3911600, e-mail : cri@criexports.com website : crigroups.com

BOMBAS C.R.I. ESPAÑA, S.L.

Poligono Industriail El.Bony Calle 31, No. 137, 46470
Catarroja (Valencia) Spain.

Tel : +34-96 1842 974, Fax : +34-96 1842 977

e-mail : cri@bombascri.es website : www.bombascri.es

BOMBAS C.R.I. ESPAÑA S.L. UNIPERSONAL

Via Linara 8, 82030, Limatola-BENEVENT O-Italy

Tel : +39. 0823 586 904

e-mail : cri@bombascri.it website:www.crigroups.com

C.R.I. BOMBAS HIDRÁULICAS LTDA

Av. Rodrigo Fernando Grillo, 457, Jd. Manacas,
CEP - 14.801-534, Araraquara - SP, Brasil.

Fone : +55-16-3331 1099, Fax : +55-16-3331 5344

e-mail : cri@cribombas.com.br website : www.cribombas.com.br

Filial : Jaboatão dos Guararapes-PE, Brasil.

Fone : (81) 3093-9620, Fax : (81) 3093-9600.

C.R.I. PUMPS S.A. (PTY) LIMITED

P.O. Box 6292, Halfway House, Midrand - 1685,
Johannesburg, South Africa.

Tel : +27-11-8058631 / 32, Fax : +27-11-8058630

e-mail : cri@cripumps.co.za website : www.cripumps.co.za

Branch : Capetown : + 27-21-9499122

C.R.I. POMPA SANAYİ VE TİCARET LİMİTED ŞİRKETİ

10032 Sk. No:12 A.O.S.B. 35620 Çiğli-İzmir-Türkiye.

Tel : +90-232-328-328 22 99, Fax : +90-232-328 23 33

e-mail : cri@cripompa.com website : www.cripompa.com

C.R.I. FLUID SYSTEMS USA LLC

1551 Mineral Springs Rd, Elberton, GA 30635 USA.

Tel:+1-2819283933, Email : sales@crigroups.us

Website : www.crigroups.us

C.R.I. PUMPS (FZE)

P.O. Box 7988, A4-12 SAIF-Zone, Sharjah, U.A.E.

Tel : +971-6-5573041 (3 Lines), Fax : +971-6-5573042

e-mail : cripumps@eim.ae website : www.cripumps.ae

C.R.I. FLUID SYSTEMS INC.,

Polyland Industrial Subdivision, Warehouse 3 Block 4,
Kendex St., Bo. Iba, Meycauayan, Bulacan. Philippines

Website : www.cripumps.ph

C.R.I. FLUID SYSTEMS (BD) LTD.,

Ground Floor, Unit-1 Holding No 212, Tejgaon Industrial Area,

Tejgaon - Gulshan Link Rd, Dhaka - 1208, Bangladesh

Website : www.cripumps.com.bd

C.R.I. PUMPS (Shanghai) Co., Ltd.

Room 902, Building No.7, 1855 Qixin Road,

Minhang District, Shanghai - 201101. China.

Tel : +86-21-54405082, Fax : +86-21-54405083

e-mail : cri@bombascri.com.cn

website : www.bombascri.com.cn

SUZHOU C.R.I. PUMPS CO., LTD.

579, Longqia Road, Wujiang District - 215200

Suzhou, China. Telephone : +86-512-634 33668

Fax : +86-512-634 33667, e-mail : cri@crisuzhou.com.cn